

Manual Set Up Instructions



Setting Correct Time and Date

Press and hold ^ and > at the same time to set the correct time and date. It's in military time see page (20). Use the ^ and > buttons to change the time and date, hit ENT when you are finished.



Selecting the Day

Once back onto the home screen press >. You should now see a Program 1 and the day (Mon, Tues, Wed, Thurs, Fri, Sat, or Sun) will be flashing. Change the day using ^ to Monday to set all the days at once or to your desired day for independent schedules, then hit enter. You will then jump down to the start and end times.



Setting Working Time

You will continue using the ^ and > buttons to change the hours of the Start Time (St). You will use ^ to increase the numbers (once it gets to 9 it will start at 0 again) and use > to shift over to the End Times (Et). Once you have entered in the Start and End times do not hit ENT but continue using > to shift down to the frequency settings.



Setting Frequency

Use the ^ button to increase the numbers and > to shift over to the next number. W is for working seconds and P is for pausing seconds. Start with W:20 seconds and P:250-280 seconds. If you want to program a separate time for it to run (Program 2) then continue pressing > until it says "Program 2" in the top left. Follow instructions as normal and hit ENT. If you do not want to set a Program 2 just hit ENT after you finish the Frequency for Program 1 and your diffuser will start running.



Military Time Conversion Chart

1:00am = 1:00	1:00pm = 13:00
2:00am = 2:00	2:00pm = 14:00
3:00am = 3:00	3:00pm = 15:00
4:00am = 4:00	4:00pm = 16:00
5:00am = 5:00	5:00pm = 17:00
6:00am = 6:00	6:00pm = 18:00
7:00am = 7:00	7:00pm = 19:00
8:00am = 8:00	8:00pm = 20:00
9:00am = 9:00	9:00pm = 21:00
10:00am = 10:00	10:00pm = 22:00
11:00am = 11:00	11:00pm = 23:00
12:00pm = 12:00	12:00am = 24:00

Factory Reset

To do a factory reset for your diffuser and erase all of its settings touch and press the BACK and > buttons at the same until the "System Reset?" prompt appears. Use > to shift over to "Yes" and hit ENT.

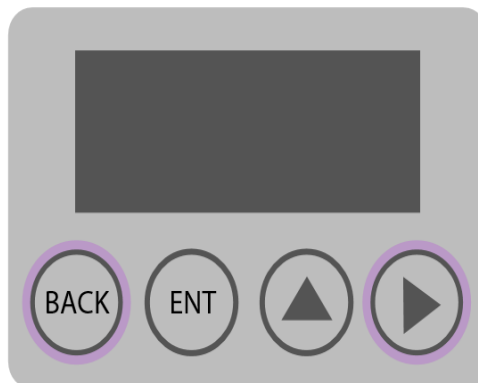

How To Mount Diffuser

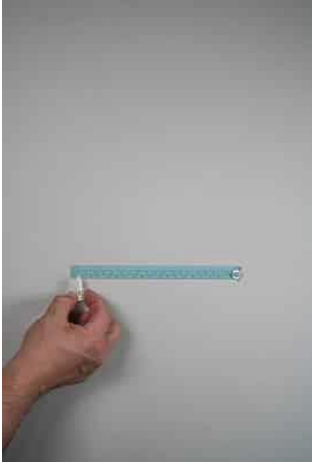

Mounting Guide

Place the mounting guide sticker on the wall next to the outflow ductwork. When installing your diffuser on sheetrock, be sure to use the provided anchors. If you are mounting on wood, only screws are needed.



Screws

Drill the screws into the x's on the mounting guide



Match the Holes

Before mounting, insert the cord into the back of the diffuser. Do not plug into a power outlet until installation is done. Match the holes on the back of the diffuser with the mounting screws

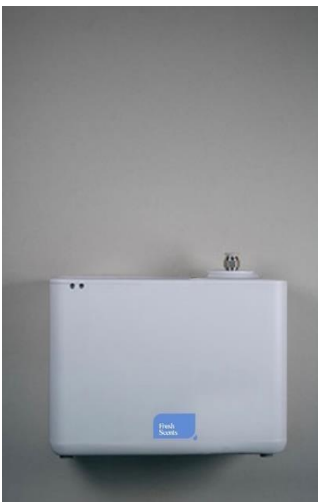

Nozzle

Place the diffuser on the screws to mount it. Screw the nozzle into the top of the Atomizer.



Grip the Atomizer

Gently pull the Atomizer straight up. Use the provided keys to unlock the Atomizer if it is locked



Pull Atomizer Out

After unlocking the Atomizer and pulling it straight up, bring it out to change bottles

Installing the Oil Refill Bottle

Step 1: Grip the Atomizer

Pull the diffuser refill upward. We provided keys to unlock the diffuser refill if it's locked.

Step 2: Pull Atomizer Out

Unlock the diffuser refill by pulling it straight up. Bring it all the way out to change out bottles.

Step 3: Screw in the Bottle

Place the dip tube into the new fragrance bottle and align with the refill diffuser. Screw the new bottle into the lid until tight.

Step 4: Back into Diffuser

Place atomizer and bottle back into the diffuser. Align the lid and the diffuser markings to push back into place. Use the provided keys to lock it.

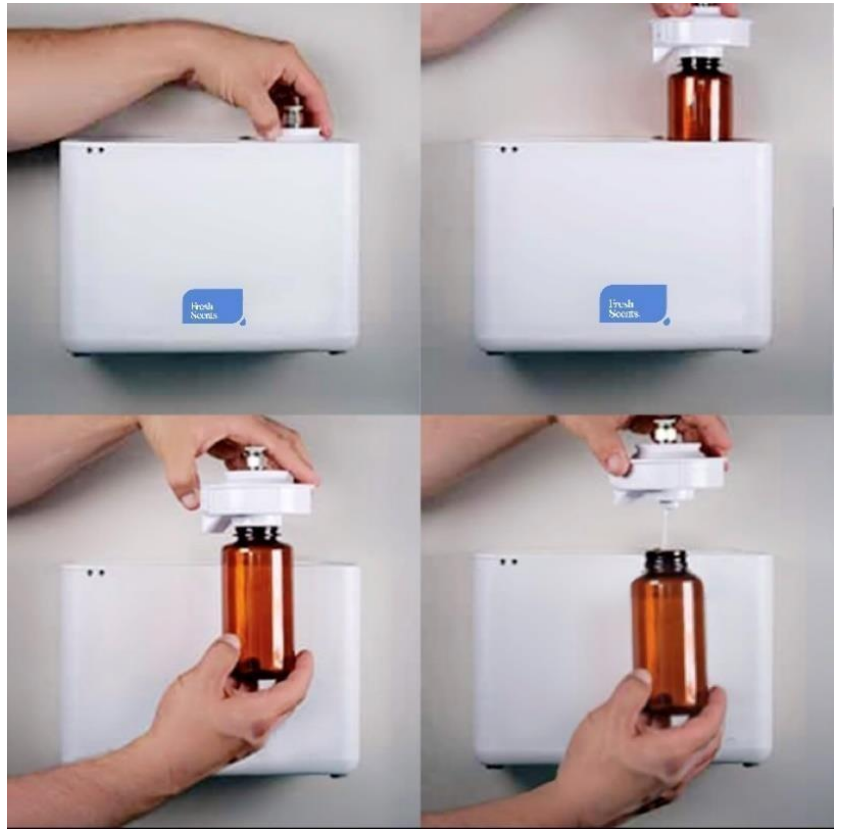

Need a Little Help?

Fresh
Scents.

For installation, troubleshooting, videos, and support email or call us at

info@freshscentsinc.com

845-208-8639