

## Installing the Oil Refill Bottle

### Step 1: Grip the Atomizer

Pull the diffuser refill upward. We provided keys to unlock the diffuser refill if it's locked.

### Step 2: Pull Atomizer Out

Unlock the diffuser refill by pulling it straight up. Bring it all the way out to change out bottles.

### Step 3: Screw in the Bottle

Place the dip tube into the new fragrance bottle and align with the refill diffuser. Screw the new bottle into the lid until tight.

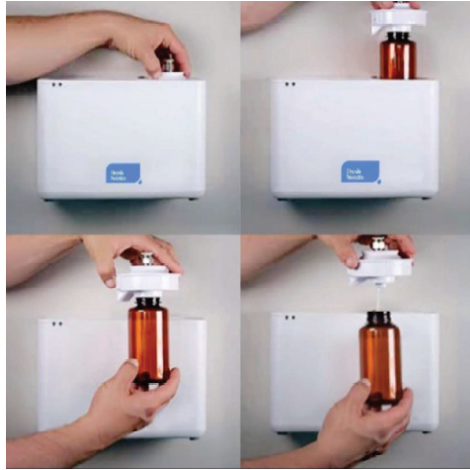

### Step 4: Back into Diffuser

Place atomizer and bottle back into the diffuser. Align the lid and the diffuser markings to push back into place. Use the provided keys to lock it.

**DO NOT POUR THE OIL DIRECTLY INTO THE MACHINE!**

**DO NOT REFILL THE DIFFUSER WITH OIL WHEN THE POWER IS ON**

**DO NOT TILT THE DIFFUSER TO AVOID FRAGRANCE SPILLS**

## Need a Little Help?



For installation, troubleshooting, videos,  
and support, email or call us at  
[info@freshscentsinc.com](mailto:info@freshscentsinc.com)  
845-208-8639

# PRODUCT MANUAL

## Aroma Oil Diffuser



## Setting Correct Time and Date

Press and hold ^ and > at the same time to set the correct time and date. This uses a 24 hour clock, so 5:59 pm is 17:59. Use the ^ to change and > to go to the next value then hit ENT when you are finished.



1:00am = 1:00	1:00pm = 13:00
2:00am = 2:00	2:00pm = 14:00
3:00am = 3:00	3:00pm = 15:00
4:00am = 4:00	4:00pm = 16:00
5:00am = 5:00	5:00pm = 17:00
6:00am = 6:00	6:00pm = 18:00
7:00am = 7:00	7:00pm = 19:00
8:00am = 8:00	8:00pm = 20:00
9:00am = 9:00	9:00pm = 21:00
10:00am = 10:00	10:00pm = 22:00
11:00am = 11:00	11:00pm = 23:00
12:00pm = 12:00	12:00am = 24:00

## Military Time Conversion Chart

## Selecting Run Time

Once back into the home screen press >. You should now see Monday flashing tap ENT and you will see program 1 flashing. Monday is the default setting for every day of the week. If you want to run the same times every day then just set up Monday and every day will run the same.

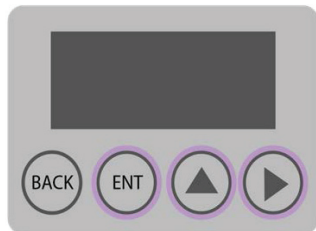

## Setting Working Time

You will continue using the > button to set the hours of the Start Time (St). You will use ^ to increase the numbers (once it gets to 9 it will start at 0 again) and use > to shift over to the End Time. Once you have entered in the Start and End times do not hit ENT but continue using > to shift down to the frequency settings.

## Setting Frequency

Use the ^ button to increase the numbers and > to shift over to the next number. W is for working seconds and P is for pausing seconds. Start with W:20 seconds and P:150-180 seconds. If you do not want to set a Program 2 just hit ENT after you finish the Frequency for Program 1 and your diffuser will start running.

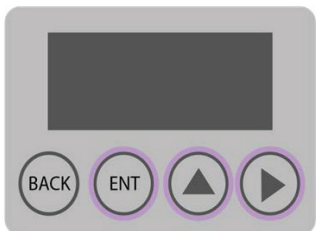

If you want to program a separate time for it to run (Program 2) then continue pressing > until Program 1 is flashing. Click ^ to set Program 2. Follow instructions as normal and hit ENT.

On top of the atomizer you can lift the fan up to blow scent horizontally instead of vertically. To turn on the fan, press the back button for 5 seconds and you will see the fan symbol on the bottom left of the window.



## Factory Reset

To do a factory reset for your diffuser and erase all of it's settings touch and press the BACK and > buttons at the same time until the "System Reset?" prompt appears. Use > to shift over to "Yes" and hit ENT.

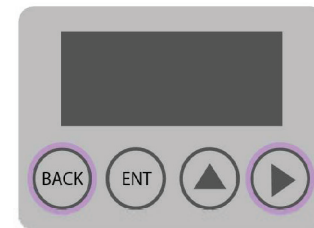

## How To Mount Diffuser

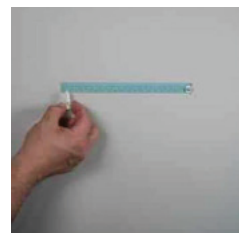

### Mounting Guide

Place the mounting guide sticker on the wall where you will be mounting the diffuser. When installing your diffuser on sheetrock, be sure to use the provided anchors. If you are mounting on wood, only screws are needed.

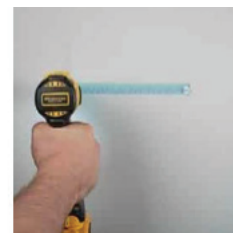

### Screws

Drill the screws into the x's on the mounting guide.



### Match the Holes

Before mounting, insert the cord into the back of the diffuser. Do not plug into a power outlet until installation is done. Match the holes on the back of the diffuser with the mounting screws.

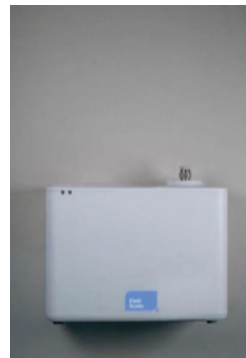

### Nozzle

Place the diffuser on the screws to mount it. Screw the nozzle into the top of the Atomizer.



### Grip the Atomizer

Gently pull the Atomizer straight up. Use the provided keys to unlock the Atomizer if it is locked.



### Pull Atomizer Out

After unlocking the Atomizer and pulling it straight up, bring it out to change bottles.